

KEN KEN IQ10e CART WASHER

Intelligent Quality

- The Future of Efficient Disinfection

- ✓ Available in four sizes
- ✓ User friendly
- ✓ Fast process time

KEN HYGIENE SYSTEMS is introducing a new range of cart washers disinfectors that will ease the daily tasks and workloads for the nursing- and healthcare facilities. The machine is available in four different sizes.

IQ10e is a sustainable solution due to its low consumption of water, electricity and detergents.

Among other things the IQ10e has an internal water recirculation system that collects the disinfection water and recycles it.

Furthermore the machine has a short process time, which makes the washing process more time efficient.

Despite of its small physical foot print, the IQ10e can still be used for washing and disinfection of larger size equipment in CSSD- and care facilities.

The machine is useful for CSSD's when washing surgical equipment, containers, vessels and utensils due to its flexible load carriers as well as for care facilities for washing wheelchairs, walking aids, toilet chairs, bowls and similar equipment.

The IQ10e represents a new generation of cart washer disinfectors with outstanding features that meet the latest regulatory standards such as EN/ISO 15883-1/2/6. This allows the IQ10e to work as a backup for the standard washer disinfectors in a CSSD.



CART WASHER



The IQ10e is made to be an eco-friendly machine. By monitoring cycle parameters and variables and with dedicated programs the machine will always seek to optimize water, energy and chemical consumption by its built-in control functions.

Advantages:

- Intelligent water savings
- User friendly control system
- Water recirculation
- Increased productivity
- Low energy costs
- Low chemical usage
- Very low water consumption
- Flexible trolleys
- Low noise level
- Remote service

Technical specification	IQ10e-S	IQ10e-SL	IQ10e-WS	IQ10e-WL
External dimensions (HxWxD) mm	2450x2500x2540	2450x2500x3340	2450x2960x2540	2450x2960x3340
Usable chamber space (HxWxD) mm	1875x970x2200	1875x970x3000	1875x1200x2200	1875x1200x3000
Preheating tanks capacity	250 + 120 liters			
Electrical connection	400 Vac3N 50 Hz			
Total electrical consumption	90 kW electric version 20 kW steam version as standard			
Water pressure inlet	200-800 kPa			
Water 1 connection	Cold water: ¾" RG, 5-30 °C, 0-30 °C dH			
Water 2 connection	Hot water: ¾" RG, 30-70 °C, 0-3 °C dH			
Water 3 connection	Demi water: ¾" RG, 5-70 °C, 0-3 °C dH, conductivity 0-200 µS			
Water recirculation pump	4.0 kW high pressure pump inverter controlled			
Water recirculation flowrate	Up to 700 l/min			
Drying air filtration	Class H14 according DS EN 1822			
Drying blower	High pressure pump 4.0 kW			
Drain	Ø100 mm			
Noise level	< 63 dB			
Max relative humidity	80 %			
Operative environment	Temperature and humidity: 5°C - 40°C, ≤ 80% RH for temperatures up to 31°C			



LTE Scientific Ltd
Greenbridge Lane, Greenfield, Oldham, OL3 7EN

E-mail: info@lte-scientific.co.uk
Web: www.lte-scientific.co.uk
Tel: +44 (0)1457 876 221

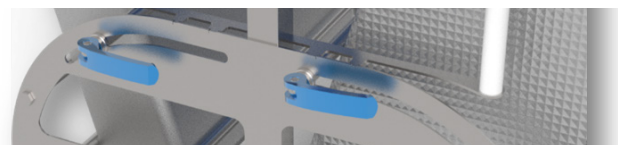

Adjustable handles for the flexible trolleys

KEN IQ10e COMPACT CART WASHER

Intelligent Quality

- The Future of Efficient Disinfection

- ✓ Water recycling
- ✓ User friendly
- ✓ Fast process time

KEN HYGIENE SYSTEMS is introducing a new range of cart washers disinfectors that will ease the daily tasks and workloads for the nursing- and healthcare facilities.

IQ10e COMPACT is a sustainable solution due to its low consumption of water, electricity and detergents.

Among other things the COMPACT has an internal water recirculation system that collects the disinfection water and recycles it.

Furthermore the machine has a short process time, which makes the washing process more time efficient.

Despite of its small physical foot print, the IQ10e COMPACT can still be used for washing and disinfection of larger size equipment in CSSD- and care facilities.

The machine is useful for CSSD's when washing surgical equipment, containers, vessels and utensils due to its flexible load carriers as well as for care facilities for washing wheelchairs, walking aids, toilet chairs, bowls and similar equipment.

The IQ10e COMPACT represents a new generation of cart washer disinfectors with outstanding features that meet the latest regulatory standards such as EN/ISO 15883-1/2/6. This allows the IQ10e COMPACT to work as a backup for the standard washer disinfectors in a CSSD.



CART WASHER



The IQ10e COMPACT is made to be an eco-friendly machine. By monitoring cycle parameters and variables and with dedicated programs the machine will always seek to optimize water, energy and chemical consumption by its built-in control functions.

Advantages:

- Intelligent water savings
- User friendly control system
- Water recirculation
- Increased productivity
- Low energy costs
- Low chemical usage
- Very low water consumption
- Flexible trolleys
- Low noise level
- Remote service

Technical specification	IQ10e-C
External dimensions (HxWxD) mm	2450x1900x1500
Usable chamber space (HxWxD) mm	1870x970x1300
Preheating tanks capacity	100 + 100 liters
Electrical connection	400 Vac3N 50 Hz
Total electrical consumption	40 kW electric version 20 kW steam version as standard
Water pressure inlet	200-800 kPa
Water 1 connection	Cold water: ¾" RG, 5-30 °C, 0-30 °C dH
Water 2 connection	Hot water: ¾" RG, 30-70 °C, 0-3 °C dH
Water 3 connection	Demi water: ¾" RG, 5-70 °C, 0-3 °C dH, conductivity 0-200 µS
Water recirculation pump	3.0 kW high pressure pump inverter controlled
Water recirculation flowrate	Up to 700 l/min
Drying air filtration	Class H14 according DS EN 1822
Drying blower	High pressure pump 4.0 kW
Drain	Ø100 mm
Noise level	< 63 dB
Max relative humidity	80 %
Operative environment	Temperature and humidity: 5°C - 40°C, ≤ 80% RH for temperatures up to 31°C



LTE Scientific Ltd
 Greenbridge Lane, Greenfield, Oldham, OL3 7EN
 E-mail: info@lte-scientific.co.uk
 Web: www.lte-scientific.co.uk
 Tel: +44 (0)1457 876 221

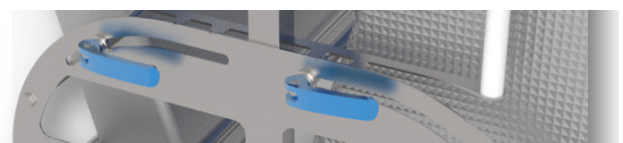

Adjustable handles for the flexible trolleys